



FMT4200

## 450mm Twin Masking Paper Dispenser

Product Instruction Manual



Scan here or go to  
[fastmovertoolsuk.com/FMT4200](http://fastmovertoolsuk.com/FMT4200)



**T:** +44 (0)1582 661993 **F:** +44 (0)1582 667100 **E:** [sales@fastmovertoolsuk.com](mailto:sales@fastmovertoolsuk.com)

# FMT4200

## Instruction Manual

### Introduction

The FMT4200 is designed to take two 18"/450mm Rolls of Masking Paper. It also features a two tool shelves.

### General Safety Instructions

- 1 Use this tool on a smooth, level, non-slip surface and always keep your working environment clean and tidy.
- 2 Do not use this tool whilst under the influence of drugs, alcohol and intoxicating medication.
- 3 Do not use this tool for any other purpose other than that for which it is intended. This tool is not intended as a tethering point.
- 4 Do not allow children and other unauthorised persons to use this equipment.
- 5 This tool has sharp edges. It is strongly recommended that hand protection is worn when using this tool.
- 6 Always be aware of those around you and keep in mind that your actions have a direct effect on your colleagues and visitors.

### Parts Diagram

Ref.	Code	Description
1	FMT4200/1	Frame
2	FMT4200/2	Tray
3	FMT4200/3	Bottom Paper Cutter
4	FMT4200/4	Top Paper Cutter
5	FMT4200/5	Paper Retainer
6	FMT4200/6	Paper Washer
7	FMT4200/7	Screw
8	FMT4200/8	Knob
9	FMT4200/9	Paper Bar
10	FMT4200/10	Star Lock Nut
11	FMT4200/11	Washer
12	FMT4200/12	Bolt
13	FMT4200/13	Axle
14	FMT4200/14	Wheel
16	FMT4200/16	Foot
17	FMT4200/17	Cutter Spring
20	FMT4200/20	Tape Reel
21	FMT4200/21	Hub
22	FMT4200/22	Bolt
23	FMT4200/23	Top Tray
24	FMT4200/24	Handle Grip
25	FMT4200/25	Hanger
27	FMT4200/27	Retaining Spring
28	FMT4200/28	Wing Nut
30	FMT4200/30	Bolt
31	FMT4200/31	Washer

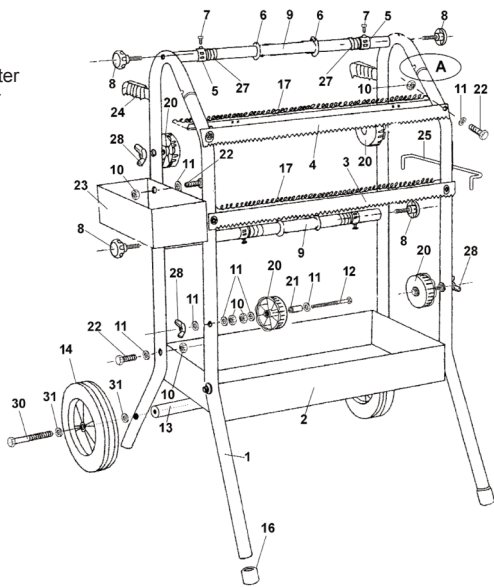

Assembly Detail 1



Assembly Detail 2

Fast Mover Tools Ltd

T: 01582 661993 F: 01582 667100 E: sales@fastmovertoolsuk.com

W: [www.fastmovertoolsuk.com](http://www.fastmovertoolsuk.com)